

## World class production parts, tooling and machines – designed and built right here in BC

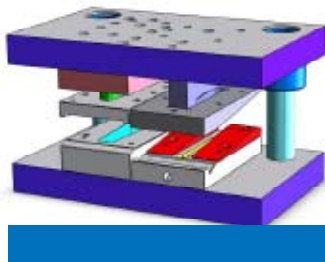

### CONSULTATION

We offer consulting services to help you make the right decisions.



### TOOL AND DIE DESIGN

Our in house design department helps guarantee quality and on time schedule.



### TOOL AND DIE MAKING

If you are looking for engineering and precision tool making, but thought you had to go out of BC to find it – now you can find it in your own back yard. We make tooling and production machinery that range from doors to battery contacts.



### PART PRODUCTION

Cost effective and efficient metal stamping is a key to your bottom line. Our metal stamping operations specialize in low, medium or high production runs, offering cost effective alternatives to CNC and laser cutting volume parts.



### ASSEMBLY

We offer a full turnkey service by assembling, packing and shipping your product to your schedule.

## Save Money with BC Metal Parts Production!

For more than 25 years Punch Tools has been Western Canada's most innovative supplier of high quality tooling and production parts. During that time numerous high profile customers from a diverse range of industries have relied on us to help make them better suppliers and improve their bottom line.

Our highly skilled workforce with more than 150 years of experience, utilizing the latest machine and computer technology, is dedicated to apply their combined knowledge to find a solution to your problem.

If it can be done – we can design, build and produce the equipment and or parts you are looking for. Our unique combination of knowledge and experience coupled with the efficiency of our own in house production facility, gives you the overall competitive edge that not even going off shore will offer. Just ask our existing customers.

If you have a great idea, but don't know how to get it off the ground, or an existing item that you need to produce more cost effectively, we can help. Whether it is for design, prototyping, small, medium or large production runs – we can do it.

So give us a call and experience the many turnkey advantages that Punch Tools Inc. has to offer.

Ask Punch Tools about putting the pieces together for you! Call us at 604.521.6444 to start saving now.

Get that good idea going – we can make it!  
Machine or parts.

## Fabricating Equipment



▲ Hydraulic Press Brake



▲ Strip Feeders



▲ Coil Handling Equipment  
Single Arbour payoff reels  
PR242500-DG model shown



▲ Hydraulic Shear

**Bettenbender  
Press Brake and Shears  
North American made quality**

## USED EQUIPMENT



▲ Used Shear 1/2" x 12'  
• Extra shear blades included  
• Very good condition



▲ Used Punch Presses  
in Stock



▲ Used Press Brakes  
• 65 ton 6' to 150 ton 10' available  
• 2 axis CNC backgauge on some  
• Call for more information

## Tooling Components



Please visit our website at [www.punchtools.com](http://www.punchtools.com) for our full online catalogs of tooling components.

## Die Set Components

**Ball bearing  
style available**



## Die springs in stock – Danly die springs now available!



Die springs are an essential component in a majority of stamping tools. They are most commonly used to actuate strippers but can also be found behind draw rings and form pressure pads. Choosing the right die spring for the application is vitally important. Improperly applied die springs will coil, set or break resulting costly repairs putting production schedules behind. Before you can determine which spring is right for your application you must know the following pressure required, travel, available space for springs. Pressure requirements vary based on the application. Established die standards for stripper pressure, ranging between 5 and 25% of the perforating pressure. The most commonly used percentages are between 10 and 15%.  
Perforating Pressure =  $S \times T \times L$  (where S=Shear Strength  
T=Material Thickness L=Length of Shear)

## Gas Springs



**When regular springs  
can't do the job**

## Hydraulic Motors

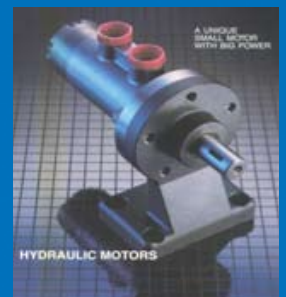

Vibratory Finishing ▶



Tumble without  
damaging parts



Auto Bend  
Correction

◀ Tube Benders

▼ Web and Beam Presses



No more  
costly drilling

Standard Web Presses

- Eye brackets adjustable for horizontal or vertical suspension
- 30 to 90 ton capacities
- Handgrips optional on all models

▼ Porta Press



Up to 40 tons from  
120 psi shop air

- Retracts instantly saving fingers
- Cell manufacturing workhorse
- Portable - only 150 lbs versus 2,000 lbs OBI

✪ For these and many more Fabricating Machines please contact us at 604.521.6444

Toolmaker  
Punches and Dies

Punch Blanks in stock

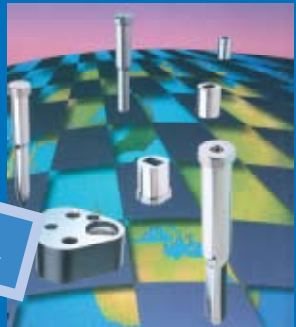

Metric and  
Imperial sizes

Precision Die Sets

Two, four and ball bearing styles available. Most sizes of standard two post in stock.

Drawing shows ordering specs for 2 post die sets

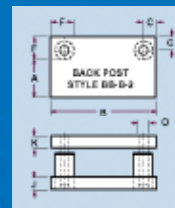
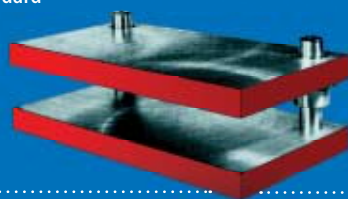

Tube Piercing Unit

Tube sizes up to 1 1/2" round or square.  
Standard 1/2" punches (larger units available)

- No die for longer punch life
- Low cost replacement parts
- 1000's of punches in stock
- Slim design allows close placement of multiple units
- Self contained dimple top and bottom

Units shown are for double dimple top and bottom. To punch top or bottom only, simply remove one punch. Also available are dimple one side only, clean punched hole on bottom. See flyer TPS125



Unitized Tooling

Still the best and most economical way to produce small to medium volume parts that need to be punched, sheared or notched. Multiple set ups of standard tooling units can achieve this very cost effectively and if your product changes so can you.



Progressive punching and notching in a single hit with no expensive custom tooling



**Part Numbering**

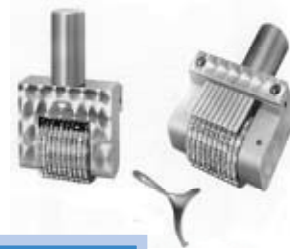

Ironworker punches and dies for all makes of machines in stock

**Shear Blades**



We supply blades for any Shear

**European Precision Tooling**

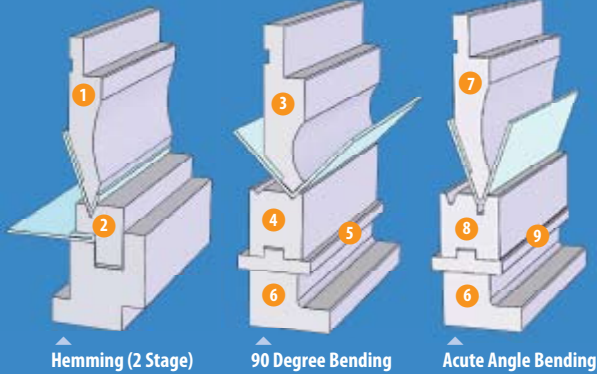

Hemming (2 Stage)

90 Degree Bending

Acute Angle Bending

**Large stock selection**

- 1 Acute Angle Punch
- 2 Hemming Die
- 3 Standard Punch
- 4 Quick Change 2V Die
- 5 Die Rail
- 6 2V Die Holder
- 7 Acute Angle Punch
- 8 Acute Angle Quick Change 2V Die
- 9 2V Die Rail
- 10 Narrow Punch
- 11 Quick Change 2V Die

Clearout SALE



90 Degree Bending with Narrow Punch

**Introducing "Magic Oil"**

Punch Tools introduces our water based metal stamping lubricant. Our customers are constantly asking us for a solution to their lubricant problems when stamping parts. "Magic Oil" answers them all.

- Lubricates punches and dies as they punch through your metal
- Stays on tool to lubricate
- Good for all metals
- Rust inhibitor on steel
- Ready to use out of the pail
- Evaporates and leaves minimal residues
- Washes clean for powder coating
- Non-toxic; No fumes; No worries
- MSDS available on request

5 gallon \$75

Obround Die and Punch



**Press Brake Tooling**  
Factory Cut-Off's in Stock

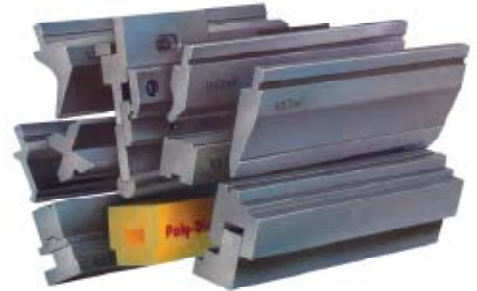

**Tooling Urethane**

Available in a variety of custom shapes and sizes. Tubes, rods, bars, sheets, for use as stripper, wear pads and metal forming.

**Tuff Brake "No Mark" Film in Stock**



**Tooling - Series 90 Now Available!**



Other tooling styles available

**24" Digital Caliper**

\$225



• Resolution to .0005"

For more information about products and services please visit [www.punchtools.com](http://www.punchtools.com)